

KNAPSACK GRANULAR APPLICATOR - CODE 414-00

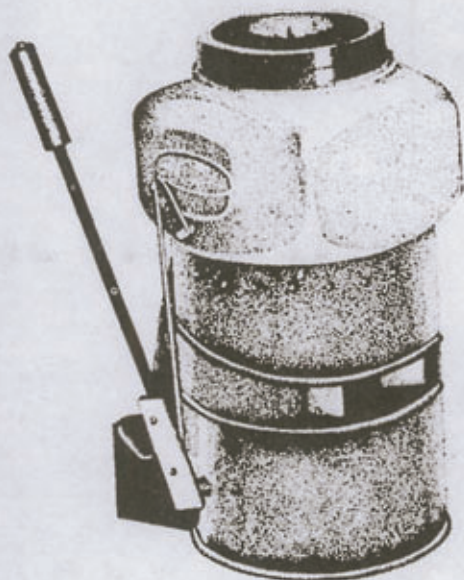

EXCELLENT FOR APPLYING MEASURED, UNIFORM AND ECONOMIC DOSAGES FOR:

- Granulated fertilizers, pesticides and fungicides;
- Vegetable, cereal and grass seeds;
- It is also perfect for the application of soil treatments such as urea, saltpetre and sulphur.

Lightweight apparatus developed for small and medium size agriculture.

Economic and versatile, replacing, with great advantages and at no risk for the operator, all the manual "spreading" applications. Special features:

- **OUTPUT RATE:** Progressive Regulated.
- **HIGH PERFORMANCE:** Larger treated area with less effort.
- **SUPER TRANSMISSION BOX:** Permanently lubricated, individually run-in and tested. Made from reinforced NYLON. More durable!
- **MORE POWERFUL FAN:** Great results with minimum effort. Allows high spreading rates.
- **ERGONOMIC OPERATING LEVER:** For ease of use and improved operator comfort.

This GRANULAR APPLICATOR, by its design, quality and performance, is certainly the ideal product to apply seeds, pastes and granules of all types, in areas where tractors are unable to reach or where mechanised applications are not feasible or economical.

SPECIFICATIONS

Net weight	6 kg (13.2 lbs)	Chemical tank	polyethylene
Tank capacity for:		Structure	tin plated steel
seeds	2 to 6 kg (4.4 a 13.2 lbs)	Paint	Epoxy
granules	4 to 8 kg (8.8 a 17.6 lbs)	Lubrication	Permanent
powder formulations	6 to 8 kg (13.2 a 17.6 lbs)	Packaging	335 x 335 x 565 mm (13.2" x 13.2" x 22.3")

SPARE PARTS

ITEM	NAME	CODE
01	Chemical tank lid	2589
02	Chemical tank	4220
03	Triangular link	3041
04	Support strap	9987
05	Agitator shaft	4219
06	Agitator	9821
07	3/8" nut	2447
08	K51 Repair kit for agitator	9823
09	Bearing	2269
10	Fan chamber lid	3871
11	Fan rotor	9652
12	Cotter pin	3210
13	Actioning rod	5769
14	M5 Nut	6002
15	M5 x 10mm screw	3465
16	Sealing washer	3464
17	M5 x 15mm screw	5999
18	Structure	4157
19	3/16" spring washer	1060
20	Complete transmission box	9658
21	Actioning shaft support	5962
22	Reinforced plate	5964
23	Plain washer	3483
24	LH thread nut	5691
25	Self locking nut	5274
26	M 6 nut	2438
27	Internal support for lever	4110
28	M6 spring washer	2439
29	External support for lever	5766
30	Screw	5768
31	Flexible lever	5767
32	Lever protector	5770
33	Handgrip	4230
34	Washer	1049
35	Lock ring	5773
36	Ball	3216
37	1/8" plain washer	3853
38	1/8" x 5/8" screw	3358
39	1/8" x 2" screw	3851
40	Felt washer	2278
41	Bushing	3826
42	Complete rotor shaft	9659
43	Gear box	9232
44	Main gear	9640
45	Helicoidal gear with pinion	3357
46	Gearbox cover	9233
47	1/8" nut	3234
48	Oil plug	3852
49	Complete lever	9977
50	M5 x 10mm screw	6000
51	M5 nut	2469

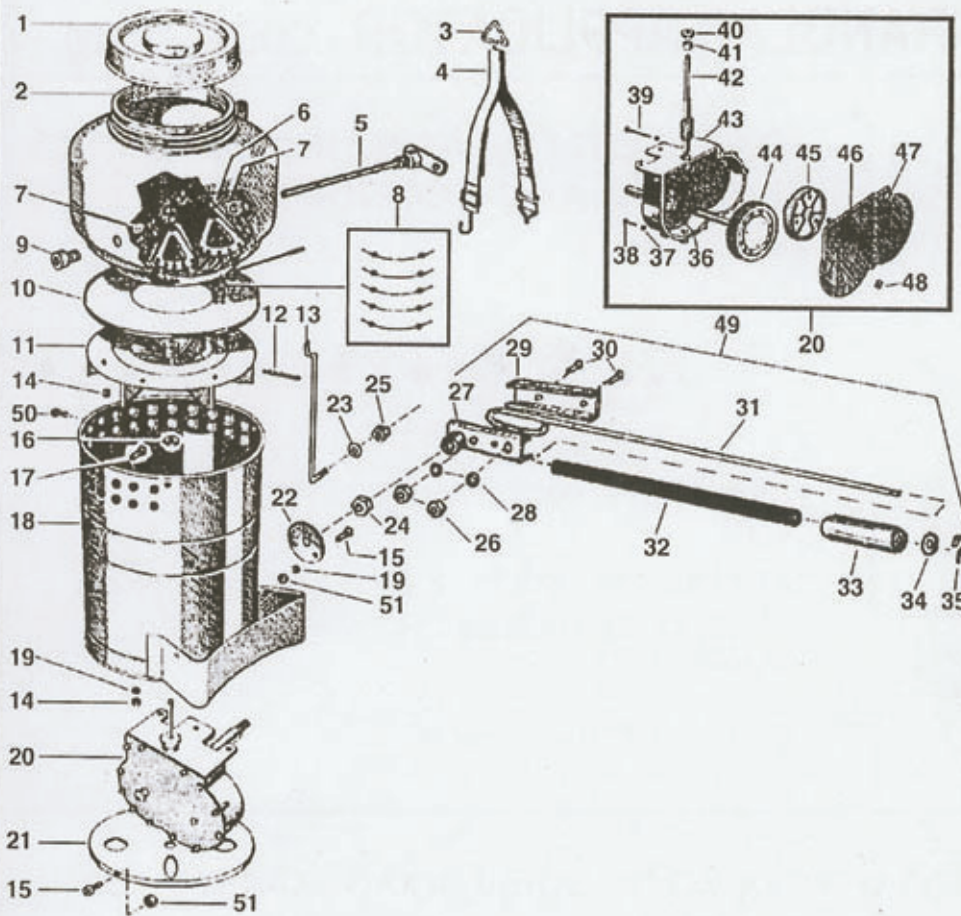

INSTRUCTIONS

- 1- Fill the chemical tank with the chosen product. **Important:** This product must be dry and free of debris. Close tightly.
- 2- Move the output regulator to the middle position.
- 3- Place the machine on the back and work the lever, slowly at first and then at the desired rate.
- 4- Regulate the output in accordance with the rate at which the lever is worked. The greater the output, the faster the rate of action.
- 5- At the end of the day's work, close the output regulator completely, but continue working the lever until any residual product is eliminated.
- 6- In case of long periods without use, wash the machine, dry it carefully and store it with the lid open in a dry and airy place.
- 7- Regularly inspect the nylon sweepers, replacing them when necessary. Each machine contains a spare kit of 5 nylon sweepers.

INSTRUCTIONS FOR REPLACING THE NYLON SWEEPERS

- 1- Insert the line in the appropriate channel (fig. 01).
- 2- Ensure that the end of the line passes through the lateral hole in the channel (fig. 02).
- 3- Pull on the end of the line with pliers.
- 4- Repeat the operation with the other end of the line in the other support.

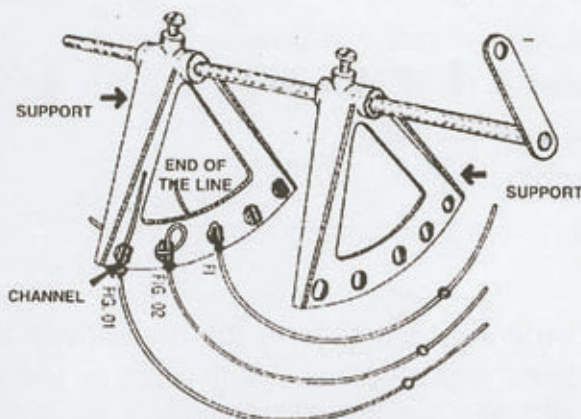

USEFUL TIPS

When emptying the product from the tank, continue to work the lever for a few more minutes until the discharge is totally clear, then refill the tank and restart the application.

ATTENTION: In order to allow the application of sulphur, or any other product which is difficult to spread, mix a small quantity of lime or industrial (inert) talcum powder with the product.

Repairs must be carried out by an Authorized Guarany workshop or at the factory.

For further details regarding Technical Assistance, please fax our International Service Dept: (55 11) 533-4565.

ATTENTION

- Take great care when using agrochemicals.
- Wear overalls, safety vest, boots, hat, gloves, respirator and goggles.
- Wash overalls at the end of each day's work.
- Don't dust upwind or on windy days.
- Follow the instructions of the agrochemical manufacturer closely.
- Wash the machine thoroughly before making repairs.

AVOID WASTE OF AGROCHEMICALS

Always quote the code number when ordering parts.